

KA005A
Knit Collar/ Waistband Setting Machine

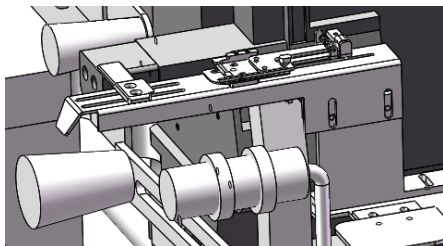



Sewing Guide Design



Touch Panel Screen Operation

For attaching T-shirt collar or elastic wasitband. De-skilling the operation with digitize tension control mechanism.

- Program controlled fabric feeding. Eliminating manual tension handling by operators.
- Enable configuration of variable feeding amount throughout different segments of each program-able sewing cycle, thus enabling quick change-over for different styles and sizes with consistent smooth finishing appearance.
- Simple setup of tension contol through “test sewing” mode input.
- Automatic parameter generation for all sizes base on base-size input.
- Output up to 130 pcs/ hr.

APPLICATIONS

Styles

T-Shirts and Pands
with Elastics Wasitband

Size and Dimensions

Collar Height: 1.2-2.5cm
(exclude seam allowance)

Fabrications

Body Fabric: Double Face, French Terry,
Jersey, Pique
Collar: Rib, Self-fabric
Prior testing is suggested for other fabrications

qonvolv
SYSTEMS

Quaternion Hong Kong Limited
13/F, Harbour Center, 25 Harbour Road
Wanchai, Hong Kong

| www.qonvolv.com
| qonvolvSystems@qonvolv.com



SPECIFICATIONS



Sewing Machine Head
PEGASUS ETX5114



Dimensions (mm)
L: 1,200 x W: 800 x H: 1,115



Stitch Type
**Overlock Stitch
(#504, #514)**



Power (W)
2,000



Compressed Air
Requirement (Mpa)
0.5



Power Supply (V)
AC 220 (50Hz)



Needle
DCx1, #9-#11



Max. Sewing Speed (rpm)
4,000



Changeover Time (m)
5



Weight (kg)
75



Output (pcs/ hr)
130